

- MATERIALS KEY:**
1. SELECTED BRICK, BIRTLEY OLDE ENGLISH BUFF OR SIMILAR
 2. ALUMINIUM WINDOWS, DARK GREY
 3. ALUMINIUM FRAME / BRISE SOLEIL TO PENTHOUSE / SETBACK LEVEL (SAME RAL AS WINDOWS)
 4. VERTICAL STEEL UPRIGHT BALUSTRADE (SAME RAL AS WINDOWS)
 5. BLACK RENDER TO PENTHOUSE / SETBACK LEVEL
 6. PROJECTING ANGLED ALUMINIUM CLAD WINDOWS
 7. FENCING TO SCHOOL PITCH (REFER TO DOT LANDSCAPE DRAWINGS FOR DETAILS)
 8. PV PHOTOVOLTAIC PANELS TO ROOF
 9. CIRCULAR ROOFLIGHTS TO AMENITY AREAS
 10. HIT AND MISS GLASS AND ALUMINIUM PANELS + ALUMINIUM COPINGS

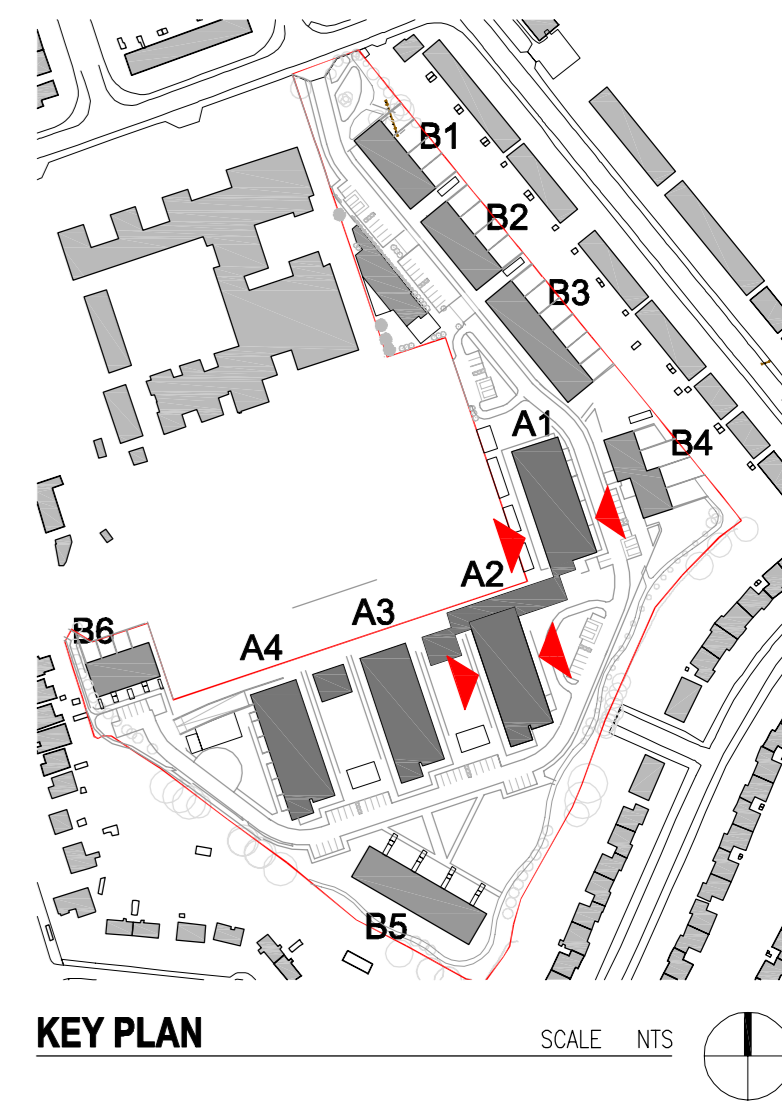

No.	Date	Revision Schedule Description
R1	18.08.2021	SUBMISSION OF SHD PLANNING APPLICATION

Scott Tallon Walker Architects
18 Merrion Square, Dublin 2, Ireland
Tel: +351 (0)1 669 3000
Fax: +351 (0)1 669 3000
Email: mail@stwalterarchitects.com
Web: www.stwalterarchitects.com

CLIENT
Clonkeen Investments DAC

PROJECT
Clonkeen Development, Co. Dublin

DRAWING: Apartment Blocks A1 and A2 - East and West Elevations

FILE REFERENCE: K:\1913\1913-PLA\Planning\19013-PLA-202.dwg

SCALE: RAO	MODIFIED TIME:
1:200	4/8/2020 11:28:25 AM
DRAWN BY: AP	CHECKED BY: SJH

PROJECT NO: 19013	PROJECT STATUS: PLANNING	PROJECT ARCHITECT: SJH
DRAWING NO: 19013-PLA-202	REVISION: P1	